

# Metal Detector

## Introduction

This metal detector can be used for the detection of metals buried underground. With this detector you can hunt for coins, keys, and other metallic objects. It is easy to operate. (Read this manual thoroughly before use.)

## Assembly Instruction

1. Take out all parts from the shipping carton.
2. Insert the lower shaft into the upper shaft. (Do not insert the lower shaft too deep.)
3. Aim the location points on the front cover and back cover at the location hole on both sides of upper shaft until the two covers match perfectly. The Clip and the Handle should be in the same direction. (Refer to figure 2)
4. Lock the four screws into the front cover.
5. Rotate the shaft lock nut counter clockwise to secure the lower shaft.

Note:

- a. The location points are on the inner surface of the front cover and back cover.
- b. There are four screw holes on the front cover.

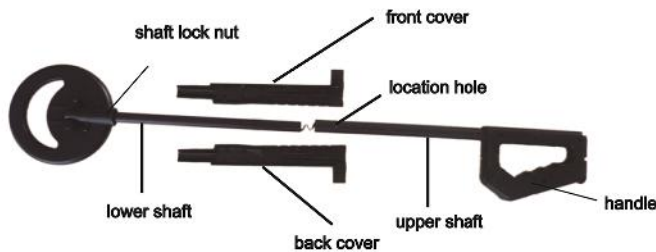

Figure 1

## Install the Battery

1. Turn off the detector with the Power/Sensitivity Knob.
2. Hold down the battery compartment cover, and slide the cover off in the direction of the arrow.
3. Insert a 9V 6F22 battery into the battery compartment according to the polarity symbols (+ and -) marked on the side of the compartment.
4. Reinstall the battery cover.

Note:

- Use only new battery of the required size and recommended type.
- Always remove old or weak battery because it may leak chemicals that can destroy electronic parts.
- If you do not plan to use the detector for a week or more, remove the battery.
- Dispose of old battery promptly and properly.

## Structure

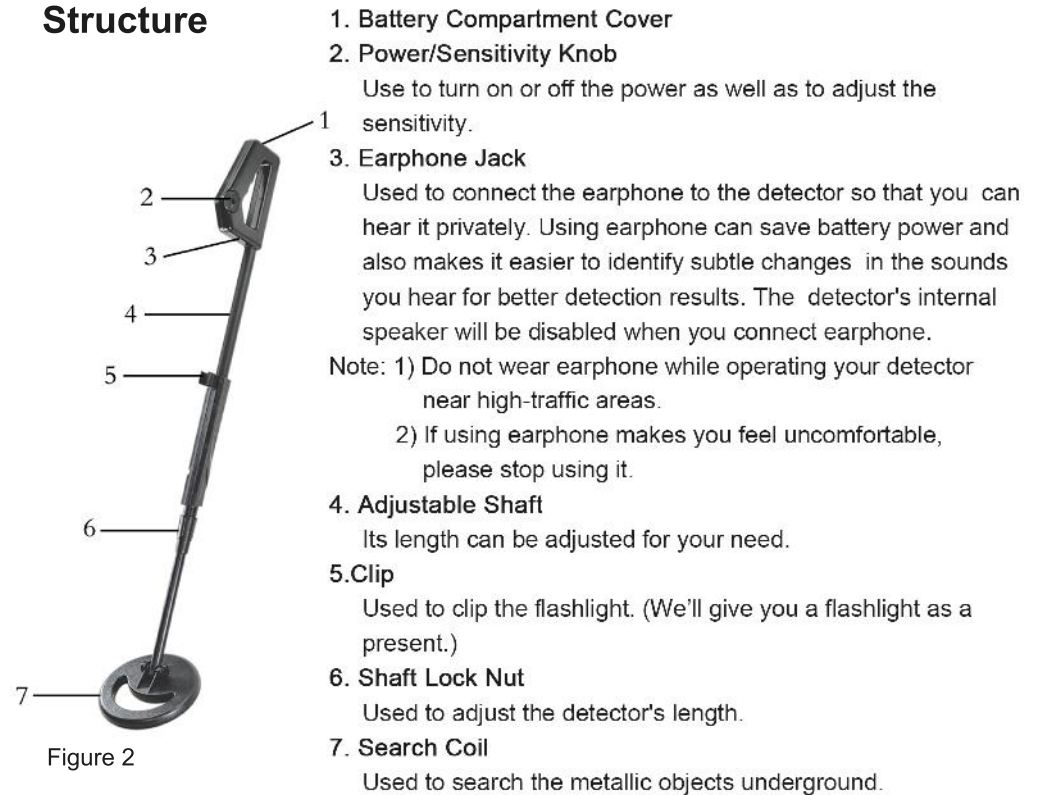

Figure 2

1. Battery Compartment Cover

2. Power/Sensitivity Knob

Use to turn on or off the power as well as to adjust the sensitivity.

3. Earphone Jack

Used to connect the earphone to the detector so that you can hear it privately. Using earphone can save battery power and also makes it easier to identify subtle changes in the sounds you hear for better detection results. The detector's internal speaker will be disabled when you connect earphone.

Note: 1) Do not wear earphone while operating your detector near high-traffic areas.

2) If using earphone makes you feel uncomfortable, please stop using it.

4. Adjustable Shaft

Its length can be adjusted for your need.

5. Clip

Used to clip the flashlight. (We'll give you a flashlight as a present.)

6. Shaft Lock Nut

Used to adjust the detector's length.

7. Search Coil

Used to search the metallic objects underground.

Note:

• Adjust the Shaft

- ① Turn the shaft lock nut clockwise until it loosens.
- ② Lengthen or shorten the shaft as you need.
- ③ Turn the shaft lock nut counter clockwise to lock it in place.

• Adjust the Search Coil

- Loosen the knobs on the search coil, then adjust the search coil to the desired angle. Tighten the knobs just enough to keep the search coil from rotating or wobbling.

## Operating Instruction

No detector is 100 percent accurate, various conditions influence metal detection. The detector's reaction depends on a number of things:

1. The angle at which the object rests in the ground
2. The depth of the object
3. The amount of iron in the object
4. The size of the object

### Pinpointing a Target

Accurately pinpointing a target makes digging it up easier. Sometimes, targets are difficult to accurately locate due to the sweep direction. Try to change your sweep direction to pinpoint a target.

Follow these steps to pinpoint a target:

1. Keep the detector far away from any metallic object. Turn the sensitivity knob clockwise, at first the detector is switched on, continue turning the knob in the same direction until it sounds continuously, the sensitivity increases gradually, then turn this knob back slowly until the sound just stops. Now the detector has the max. sensitivity.  
If you want to set the detector to a lower sensitivity level, you can use a known metallic object to verify it by adjusting the sensitivity knob until you get the desired sensitivity.
2. When the detector detects a buried target, continue sweeping the search coil over the target in a narrowing side-to-side motion. Make a mark of the exact spot on the ground where the detector beeps.
3. Stop the search coil directly over the mark on the ground. Then move the search coil straight forward away from you and straight back toward you a couple of times. Make another mark of the exact spot on the ground where the detector beeps.
4. Repeat steps 2-3 at a right angle to the original search line, the target should be directly below the intersection of the two marks.

### Notes:

1. Before you use the detector to detect metallic object, verify the detector's operation with a known metallic object.
2. In the place of strong "mineralization reaction", too high sensitivity will cause false signals and make it hard for detection. To weaken this reaction you should decrease the sensitivity.
3. Keep the search coil about 1 inch (2.54cm) from the ground as well as parallel with the ground during detection.

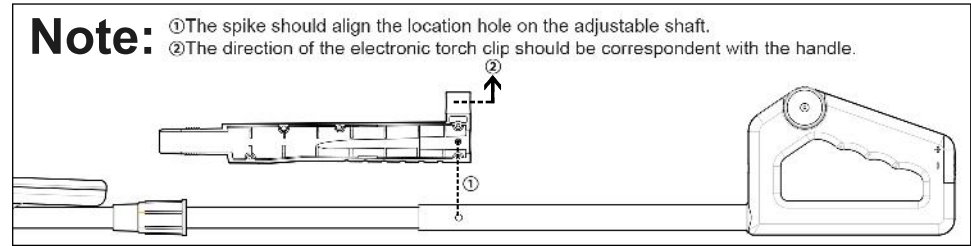

## Specification

|   |  |
|---|--|
| Max. Detection Distance in the air 【use a 25 cent coin (USD) as a target】 : more than 6cm |  |
| Length: 102cm (adjustable )   | Coil Diameter: 15.4cm                            |
| Weight: about 465g (including battery)  | Battery: 9V battery, 6F22 or equivalent, 1 piece |
| Operating Temperature: 0°C~45°C   | Storage Temperature: -10°C~50°C                  |
| Operating Aultitude: 0~2000m  | IP Degree: IP20                                  |

## Notes

All treasure hunters might be judged by the example you set. Here are a few basic rules you should follow while using your detector.

1. Observe all national, state and local laws while treasure hunting. Always get permission before searching any site.
2. Respect the rights and property of others.
3. Never destroy historical or archaeological treasures.
4. Leave the land and vegetation as it was. Fill in any holes you dig.
5. Use your detector only in safe areas.
6. Dispose of any junk you found in case of pollution.
7. If there is something wrong with the detector, please replace the battery first.

## Notes

1. This manual is subject to change without notice.
2. Our company will not take other responsibilities for any other losses.
3. The contents of this manual can not be used as a reason to use the detector for any special application.

### DISPOSAL OF THIS ARTICLE

Dear Customer,

If you at some point intend to dispose of this article, then please keep in mind that many of its components consist of valuable materials, which can be recycled.

Please do not discharge it in the garbage bin, but check with your local council for recycling facilities in your area.

